



WICKLOW COUNTY COUNCIL
COMHAIRLE CHONTAE CHILL MHANTÁIN

**ROAD TRAFFIC ACT 1994
TRAFFIC CALMING MEASURES**

Wicklow County Council in exercise of the powers conferred upon it by Section 38 of the Road Traffic Act, 1994, hereby gives notice that it is proposed to provide traffic calming measures, at locations listed below in the Municipal District of Bray, which restrict or control the speed or movement of, or which prevent, restrict or control access to a public road or roads by, mechanically propelled vehicles in the interest of the safety of road users.

Location	Measures
Strand Road and Harbour Road, Bray	Three speed tables and road narrowing to facilitate pedestrian and cycle crossing points for the new schools access via Bray Harbour
Adelaide Road, Bray at junctions with Florence Road and Quinsborough Road	Two Speed table, road narrowing and zebra crossing at accident locations
Briarwood, Vevay Road, Bray	Traffic ramp across entrance to facilitate drainage and traffic safety.

Plans and particulars will be available for inspection, from Wednesday 12th July, at the offices of Municipal District of Bray, Civic Offices, Main Street, Bray, Co. Wicklow between 9:00am-1.00pm and 2:00pm-5.00pm Monday to Friday (except public holidays) and at Bray Public Libraries at Eglinton Road and Boghall Road during library opening hours.

Representations on the proposed traffic calming measures may be submitted in writing to the undersigned on or before noon, Wednesday the 16th August 2017. Submissions should be headed, "Traffic Calming 2017."

Wicklow Council is committed to Access For All. This document is available in alternative format on request.

David Forde,
Bray District Administrator,
Wicklow County Council,
Municipal District of Bray,
Civic Offices, Bray, Co. Wicklow

Phone: 01 2744900
Fax: 01 2860930
Email: braymd@wicklowcoco.ie



WICKLOW COUNTY COUNCIL
COMHAIRLE CHONTAE CHILL MHANTÁIN

**SECTION 75 – ROADS ACT, 1993
PROVISION FOR TEMPORARY
CLOSURE OF PUBLIC ROAD**

Wicklow County Council hereby gives notice that it proposes the temporary closure of public roads, L4371 and L4372 at the locations listed below on 10th September, 2017, from 10.55 a.m. to 12.45 p.m. to facilitate a charity 10km road race which is being held by Lakeshore Striders, Blessington.

- Haylands to Crosscoolharbour (L4371)
- Crosscoolharbour to Threecastles (L4371)
- Threecastles to Manor Kilbride (L4371)
- Manor Kilbride to Oldcourt (L4372)
- Oldcourt to Butterhill (L4372)
- Butterhill to Blessington (L4372)

Marshalls will be on duty at each location to advise road users of alternative routes.

Each section of road will be re-opened as the race passes through.

Any person wishing to object to the proposed road closure must lodge their objection in writing with the undersigned not later than 12 noon on Tuesday, 18th July, 2017.

Allyson Minion, Administrative Officer,
Transportation & Roads Infrastructure,
Wicklow County Council, County Buildings, Wicklow

**SECTION 75 - ROADS ACT, 1993
PROVISION FOR TEMPORARY
CLOSURE OF PUBLIC ROAD**

Wicklow County Council hereby gives notice that it

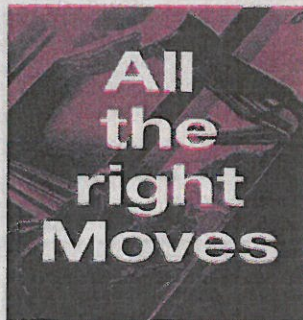

In our **Property** section



Kildare and Wicklow
Education and Training Board

**TENDERS FOR CATERING
SERVICE CONCESSION AT
BRAY INSTITUTE
OF FURTHER EDUCATION**

ESTATES

REY

REY

REY

REY

REY

REY

REY

REY

REY

REY

REY

REY

REY

REY

REY

REY

REY

REY

REY

REY

REY

REY

REY

REY

REY

REY

REY

REY

REY

REY

REY

REY

REY

REY

REY

REY

REY

REY

REY

REY

REY

REY

REY

REY

REY

REY

REY

Wicklow County Council
MUNICIPAL DISTRICT OF BRAY
Road Traffic Act 1994
Traffic Calming Proposals 2017

Introduction:

- Pursuant to the provisions of **Section 38 of the Roads Act, 1994** Wicklow County Council have given notice of its intention to provide traffic calming at locations listed below, which restrict or control the speed or movement of, or which prevent, restrict or control access to a public road or roads by, mechanically propelled vehicles in the interest of the safety of road users.

Location	Measures
Strand Road and Harbour Road, Bray	Three speed tables and road narrowing to facilitate pedestrian and cycle crossing points for the new schools access via Bray Harbour
Adelaide Road, Bray at junctions with Florence Road and Quinsborough Road	Two Speed tables, road narrowing and zebra crossing at accident locations
Briarwood, Vevay Road, Bray	Traffic ramp across entrance to facilitate drainage and traffic safety.

- Representations on the proposed traffic calming measures as outlined in plans and particulars contained herein may be made in writing to the **Bray District Administrator, Wicklow County Council, Municipal District of Bray, Civic Offices, Bray, Co. Wicklow before noon Wednesday 16th August 2017**. Submissions should be headed, "Traffic Calming 2017".
- After receipt of surveys, written representations and consideration of the observations of the Garda Commissioner/Chief Superintendent for the area and the appraisal of the council's roads technical staff, a manager's report in relation to the traffic calming measures shall be prepared and submitted to the elected members. The report shall list the persons or bodies who made submissions or observations, summarise the issues raised with respect to traffic safety and viability and recommend whether or not the proposed measures should be proceeded with as proposed or with modification.
- It is the function of the elected members collectively, following the consideration of the observations or representations, to make decisions regarding the provision of traffic calming measures.

Strand Road and Bray Harbour Traffic Calming

Funding has been allocated by means of development contributions to provide a safe pedestrian and cycle route from the Strand Road, Bray via the harbour and rail underpass to the two new schools on the Dublin Road. As part of the detailed design of the cycle/pedestrian route, which was the subject of planning reference for the two new schools, three traffic calming measures were proposed at locations where pedestrian and cycle crossings of Strand Road and the Harbour Road will occur.

On Strand Road, adjacent to Martelo Terrace, the public road has been realigned into a verge and by removal of footpath on west side so as to accommodate a planned two-way cycle track on the east side of the road. Nearer the North Promenade car park entrance, a road narrowing is required to fit the cycle track without the need for land acquisition. The removal of footpath on one side creates the need for a pedestrian crossing point at this location.

To address these requires and ensure safe traffic speeds on the approach to a sharp bend in the road and in the vicinity of pedestrian and cycle movements, a traffic calming measure is proposed where the road is narrowed to 3.6m, which will force traffic for each direction to take turns passing through a short one-way shuttle. This would also incorporate a raised speed table with a level access zebra crossing

On the Harbour Road, the proposed traffic calming comprises pavement build-outs at the entrance from Seapoint Road/Strand Road junction and immediately north of the Dockyard 8 Premises, which would reduce the roadway width to 6m at these locations. Between the buildouts a raised speed tables are included. These would be designed to provide for level access pedestrian and cycle crossings. New upgraded public lighting is planned at the Harbour Road that will provide adequate lighting of the ramps.

For the three speed tables a Hot Rolled Asphalt pavement construction with coloured stone chippings is proposed. For improved visibility, retroreflective white sharks teeth markings on each approach ramp will be provided. Additional markings to designate pedestrian/cycle crossing locations will also be included. The proposed speed table height of 80mm is proposed. Ancillary drainage work will be required.

Adelaide Road Traffic Calming

The junction of Adelaide and Florence Road has been the scene of many road accidents over several years. Funding has been allocated for Low Cost Safety Improvement grant for traffic calming at this junction. The proposal comprises the narrowing the approach roads to 6m, reducing kerb radii at the corners and the provision of a speed table over the entire junction. A zebra crossing on the northern arm of the junction is also proposed.

The proposal will complement draft proposals for an enhanced Bray Dart Interchange. This includes the provision of a cycle lane into the Dart Station along Florence Road. To improve visibility for traffic entering Adelaide Road from the Dart Station direction, it is also to provide pavement buildouts on the east side of Adelaide Road at the junction and move all parking on Adelaide Road to the east side.

At the junction of Quinsborough Road it is proposed to narrow the approach to 6m and reduce the kerb radii at the corners. A raised speed table at the Adelaide approach to the junction only is proposed. It is proposed that this will facilitate a level access pedestrian crossing for pedestrians on the south side of Quinsborough Road.

For the two speed tables a Hot Rolled Asphalt pavement construction with coloured stone chippings is proposed. For improved visibility, retroreflective white sharks teeth markings on each approach ramp will be provided. Additional markings to designate pedestrian/cycle crossing locations will also be included. The proposed speed table height of 80mm is proposed. Ancillary drainage works will be required.

Briar Wood Traffic Calming

The entrance to Briar Wood has a wide entrance from a roundabout without a deflection island leading onto a roundabout on the busy Vevay Road. There is also a risk of substantial volumes of water entering the estate from the Vevay Road and overpowering the drainage system adjacent to low lying properties in the estate. To address both issues it is proposed to provide a traffic calming ramp across the entrance to the estate.

The proposed ramp will comprise a 3.7m long round top segment reaching a maximum height of about 80mm. It will be over the full width of the entrance. A Hot Rolled Asphalt pavement construction with coloured stone chippings is proposed. For improved visibility, retroreflective white sharks teeth markings on each approach ramp will be provided. Ancillary drainage works will be included.

Appendix

Bray Traffic Calming Proposals 2016 - Location Map – sheet 1

Drawings for each of 3 traffic calming proposals – sheets 2-4

RevNo	Revision note	Date	Signature	Checked
-------	---------------	------	-----------	---------

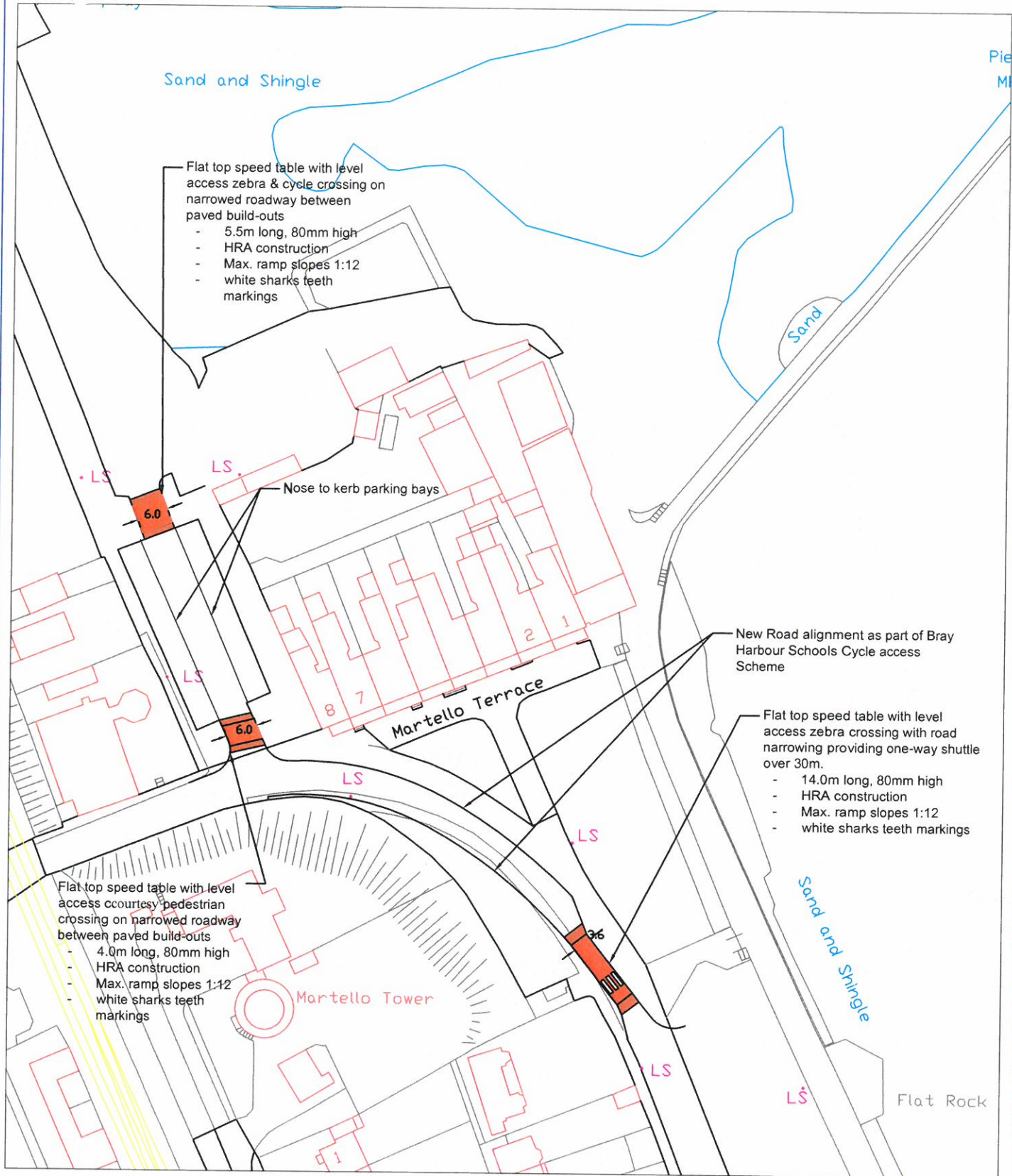

Designed by L.BOURKE	Checked by XXX	Approved by - date L.BOURKE	Filename XXX	Date 12/07/17	Scale 1:1000
Wicklow County Council Bray M.D.		STRAND ROAD & HARBOUR ROAD TRAFFIC CALMING 2017			Edition 1
		SITE LAYOUT		Sheet 2/4	

RevNo	Revision note	Date	Signature	Checked

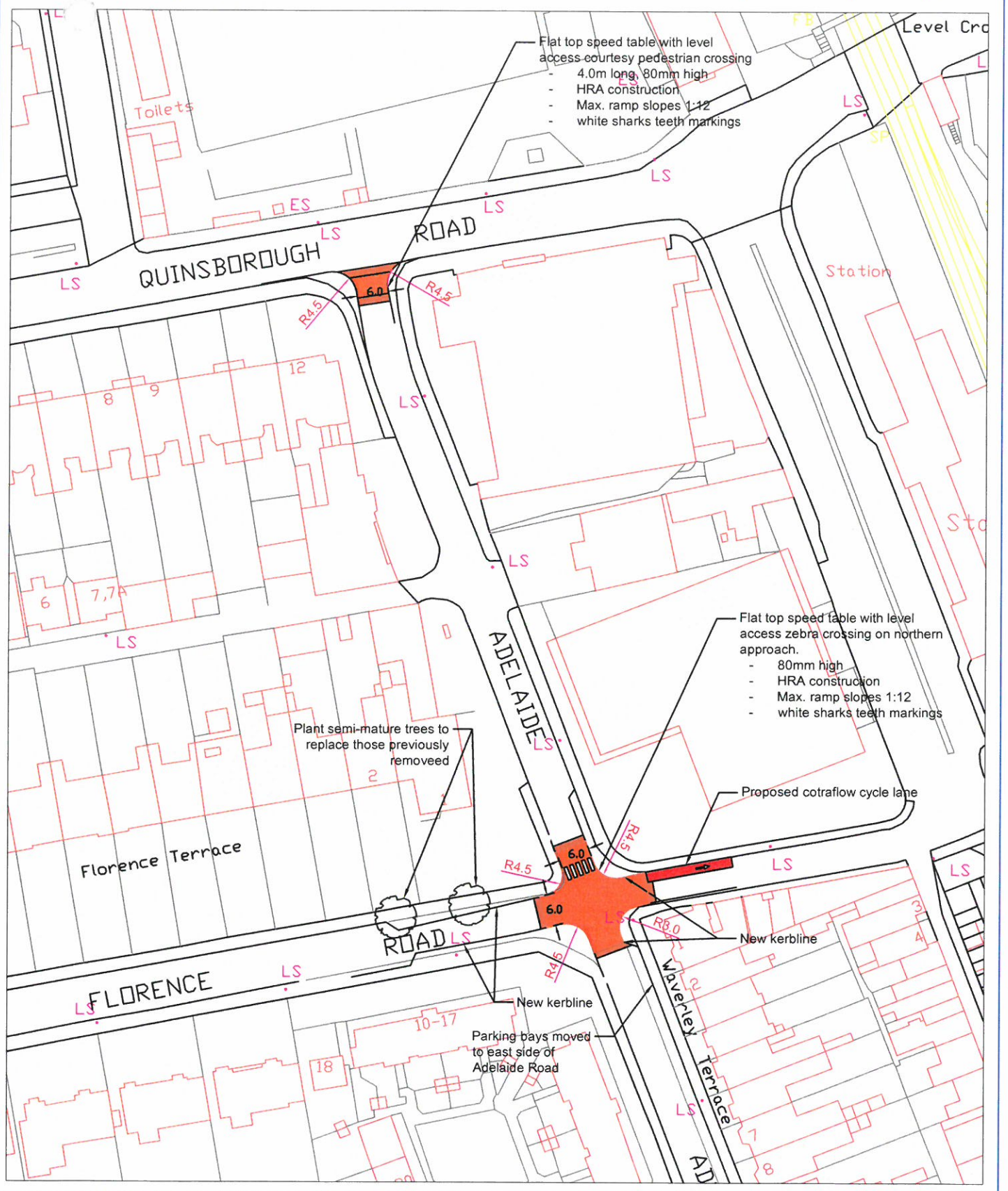

Designed by L.BOURKE	Checked by XXX	Approved by - date L.BOURKE	Filename XXX	Date 12/07/17	Scale 1:1000
Wicklow County Council Bray M.D.		ADELAIDE RD-FLORENCE RD & QUINSBOROUGH RD TRAFFIC CALMING 2017			
SITE LAYOUT			Edition 1	Sheet 3/4	

RevNo	Revision note	Date	Signature	Checked

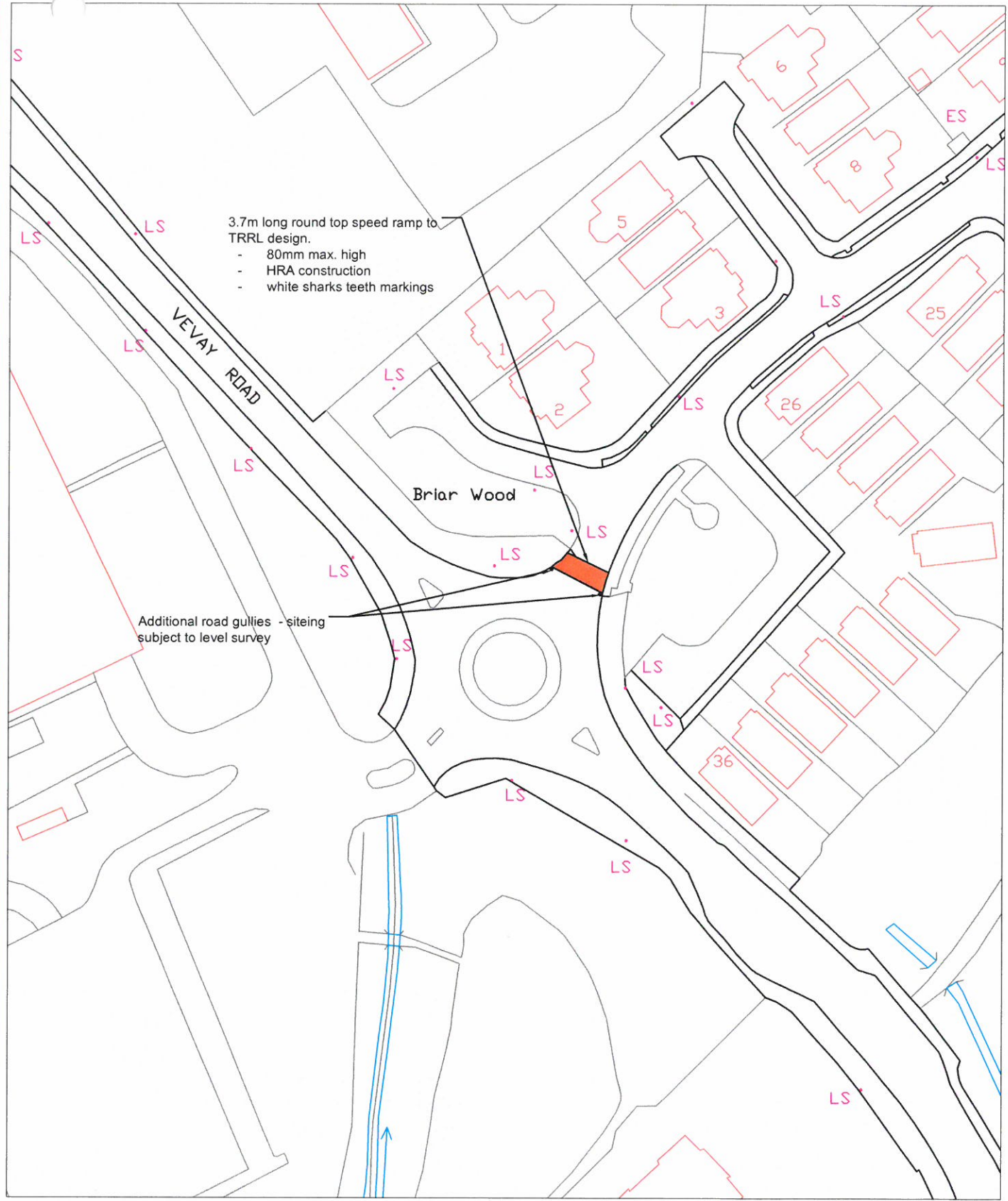

3.7m long round top speed ramp to TRRL design.

- 80mm max. high
- HRA construction
- white sharks teeth markings

Additional road gullies - siting subject to level survey



Designed by L.BOURKE	Checked by XXX	Approved by - date L.BOURKE	Filename XXX	Date 12/07/17	Scale 1:1000
Wicklow County Council		BRIAR WOOD TRAFFIC CALMING 2017			
Bray M.D.		SITE LAYOUT		Edition 1	Sheet 4/4

RevNo	Revision note	Date	Signature	Checked

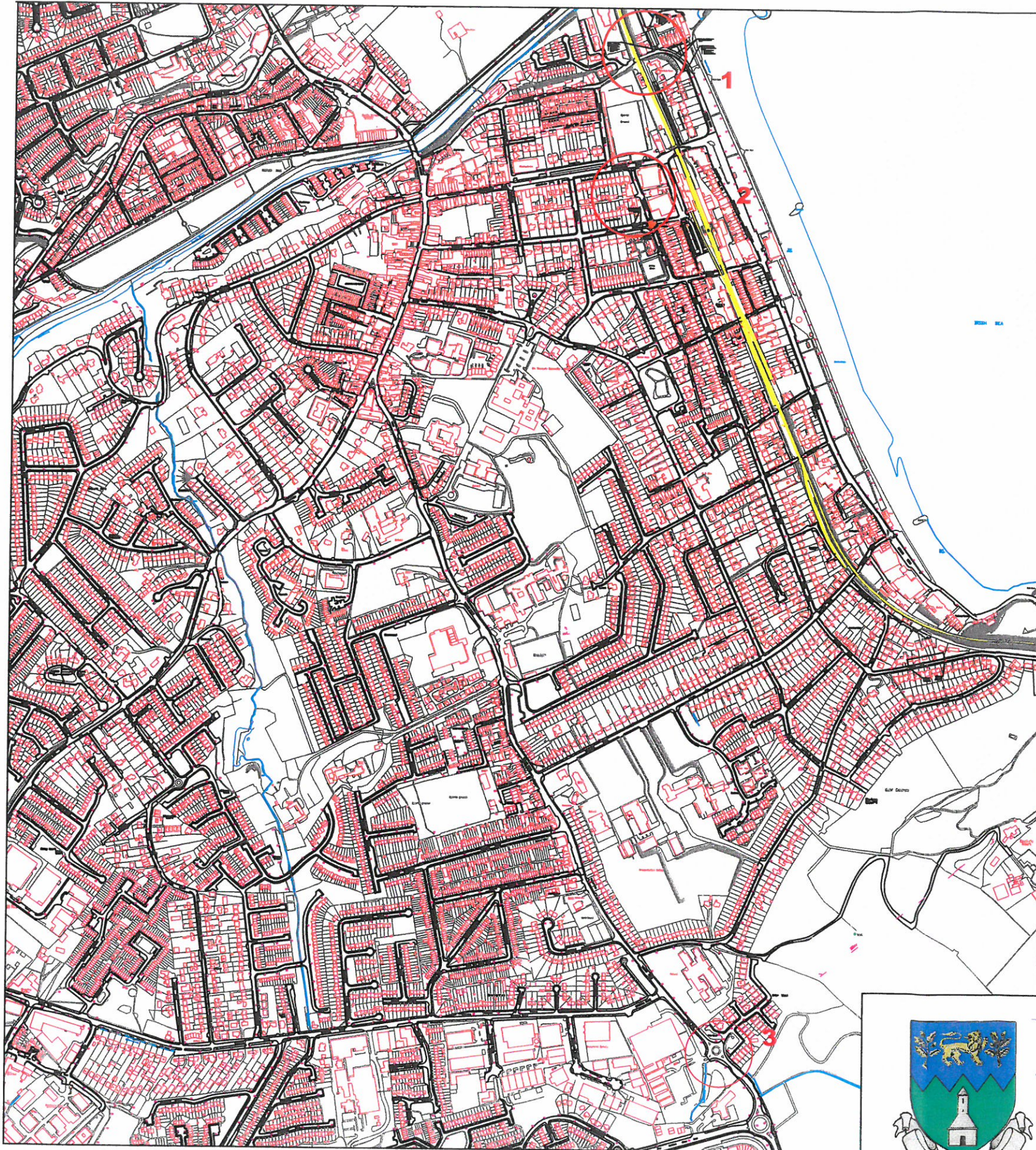

Location

1. Strand Road and Harbour Road, Bray
2. Adelaide Road, Bray at junctions with Florence Road and Quinsborough Road
3. Briarwood, Vevay Road, Bray

Measures

Three speed tables and road narrowing to facilitate pedestrian and cycle crossing points for the new schools access via Bray Harbour

Two Speed tables, road narrowing and zebra crossing at accident locations

Traffic ramp across entrance to facilitate drainage and traffic safety.



Designed by L.BOURKE	Checked by	Approved by - date XXX	Filename XXX	Date 12/07/2017	Scale 1:10,000
Wicklow County Council Bray M.D.		BRAY TRAFFIC CALMING PROPOSALS 2017			LOCATION MAP
		Edition 1	Sheet 1/4		